

Link Hardware | 8131 Keele St unit #4, Vaughan, ON L4K 1Z2, Canada
 Phone: +1 905-761-5656
 Email: info@linkhardware.ca



SERIES POCKET MIDLAND SLIDER

JUN 2025

03900849

		00993110 (PKT1A) S	2
		00993111 (PKT1MBL) BL	1
X			1
Y			8

Z		DIN 7982 4,2x16mm	2
J			1
K			1

R			1
S			1
T			2

U			2
V			2
W			2

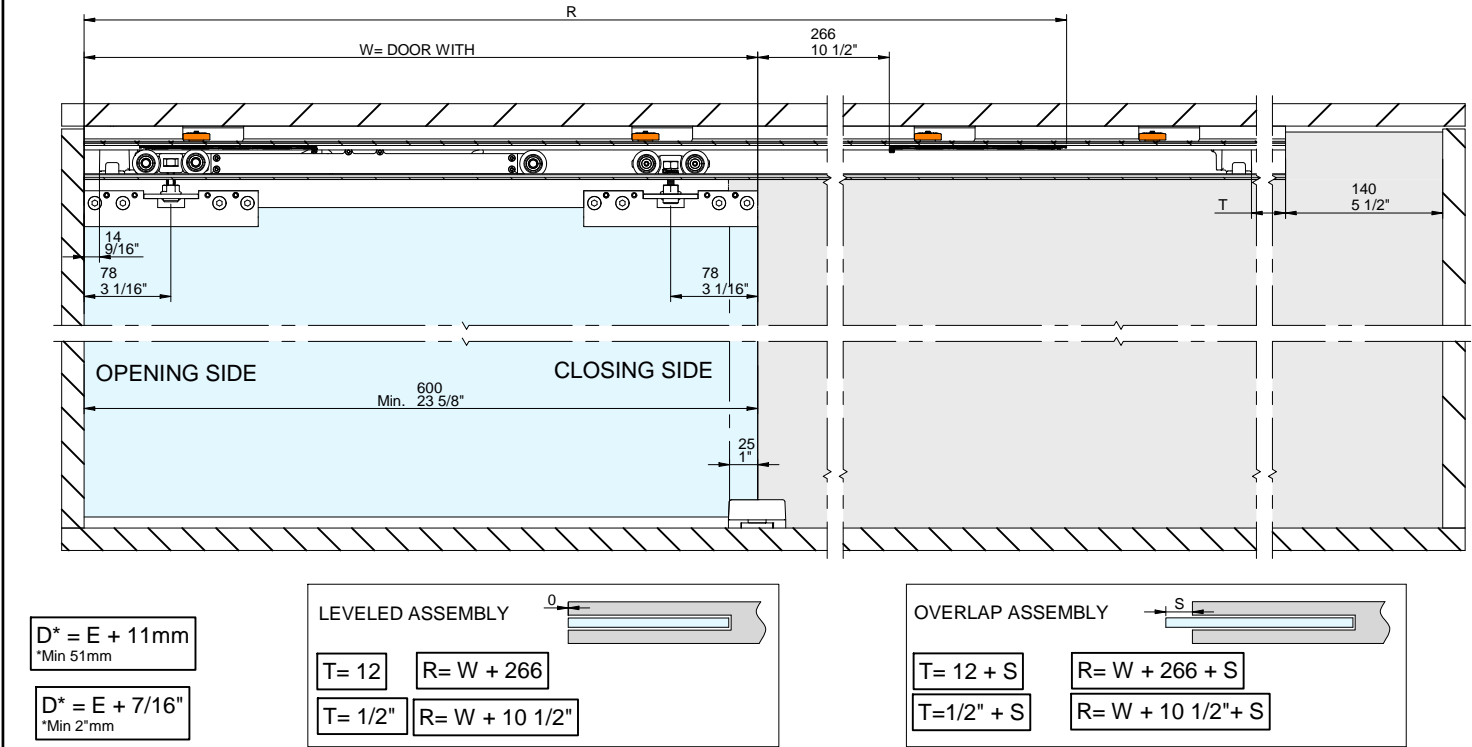
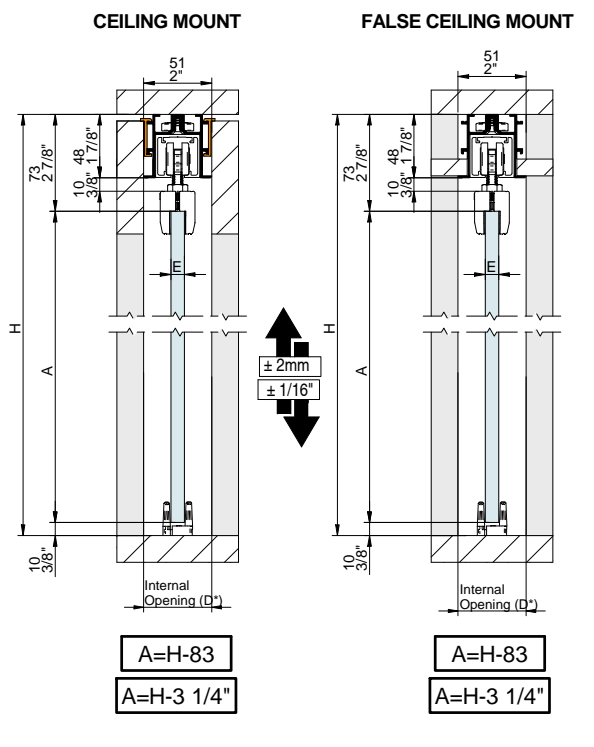

ASSEMBLY PROFILES

$X = Y + 165$
 $W = Y + 25$
 $K = (Y \times 2) + 25$

$X = Y + 6 1/2"$
 $W = Y + 1"$
 $K = (Y \times 1/16") + 1"$

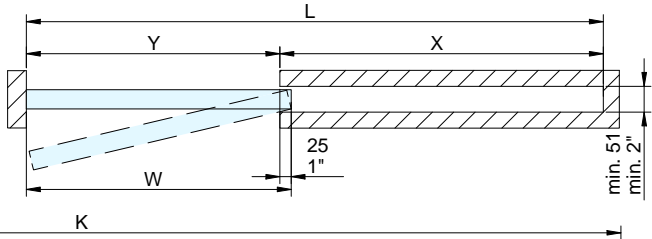

(Ymm)	(Y")	(Zmm)	(Z") MIN.
1100	43 5/16"	2100	82 11/16"
1200	47 1/4"	2100	82 11/16"
1300	51 3/16"	2300	90 9/16"
1400	55 1/8"	2500	98 7/16"
1500	59 1/16"	2700	106 5/16"
1600	63"	2800	110 1/4"
1700	66 15/16"	3000	118 1/8"
1800	70 7/8"	3400	133 7/8"

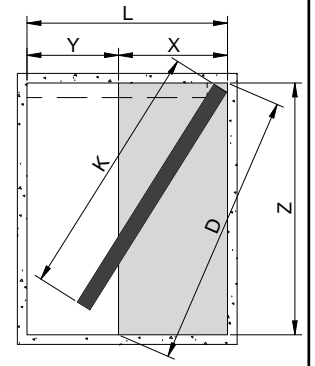

$K \leq D - 110$
 $K \leq D - 4 5/16"$

3 ASSEMBLY COMPONENTS

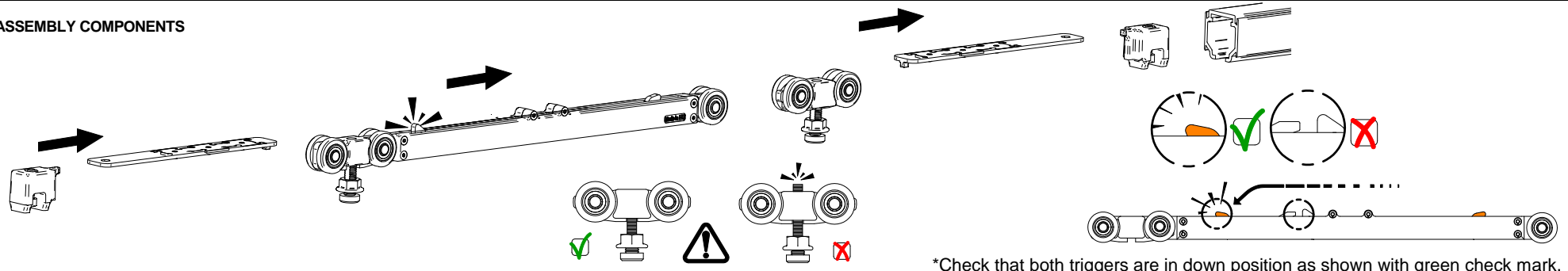

*Check that both triggers are in down position as shown with green check mark.

4 STOPPER

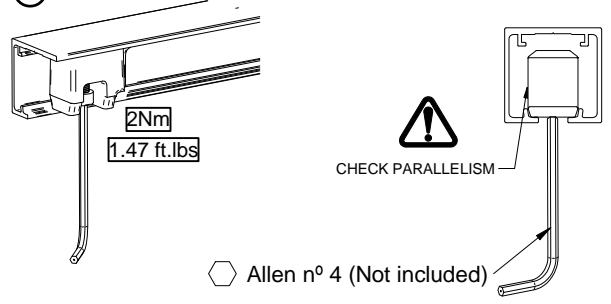

5 ASSEMBLY ACTIVATORS

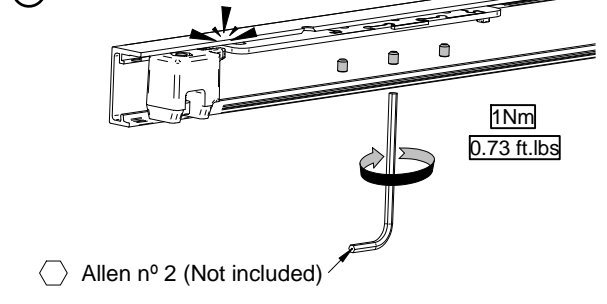

6 FIX SUPPORT TOP TRACK TO CELING

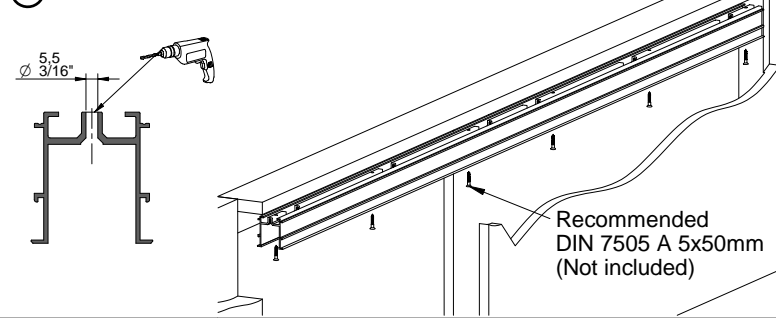

7 ACCOMODATE THE MAIN TOP TRACK TO SUPPORT TOP TRACK ALREADY FIXED

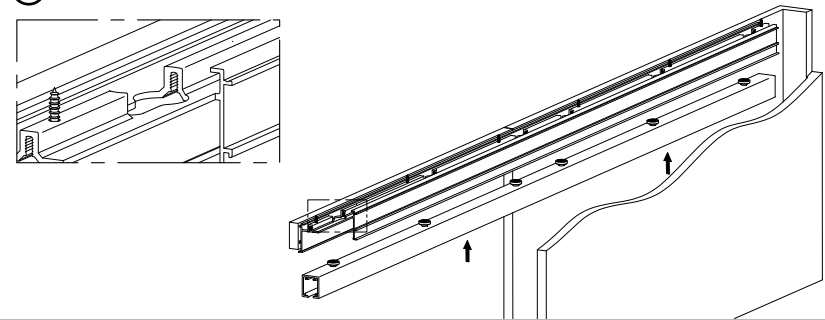

8 INSERT INTO SLOTS

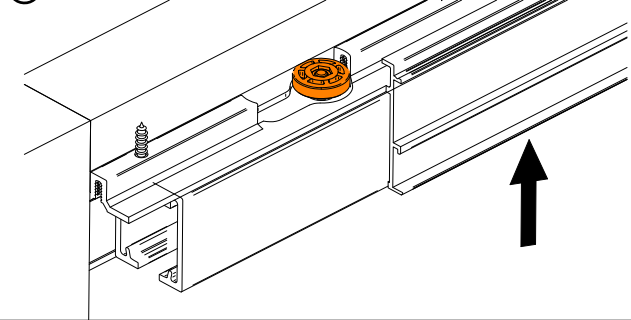

9 SLIDE UNTIL LIMIT

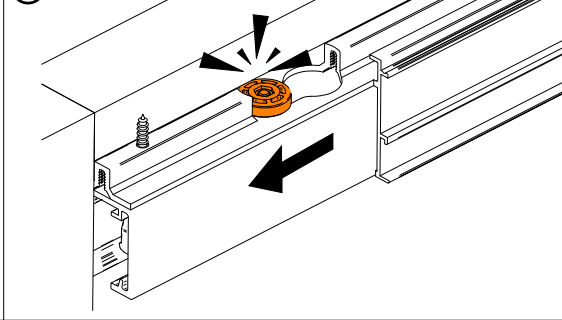

10 FIX THE TWO SCREWS (Z) IN THE CLEAR OPENING TO JOIN TRACKS

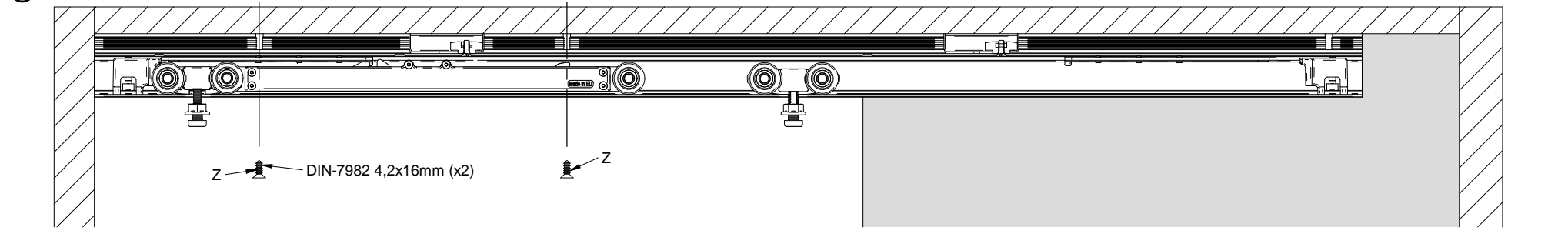

11 CLAMPS ASSEMBLY

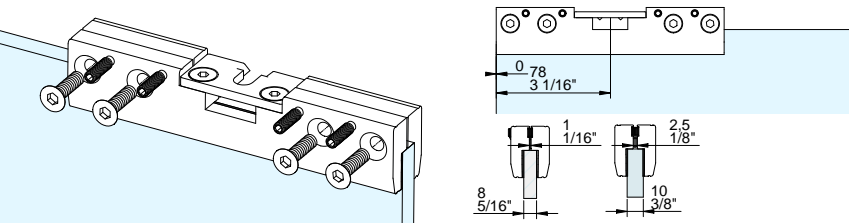

12 FIRST STEP: ADJUST GLASS THICKNESS SCREWS SECOND STEP: THIGHTEN CLAMP SCREWS THIRD STEP: TIGHTEN GLASS THICKNESS SETTING SCREWS

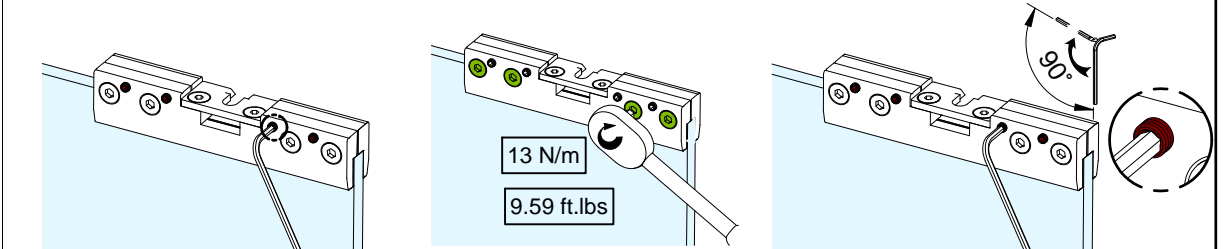

13 OPENING SIDE ASSEMBLY

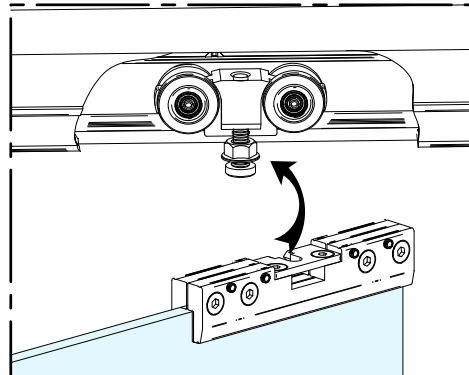
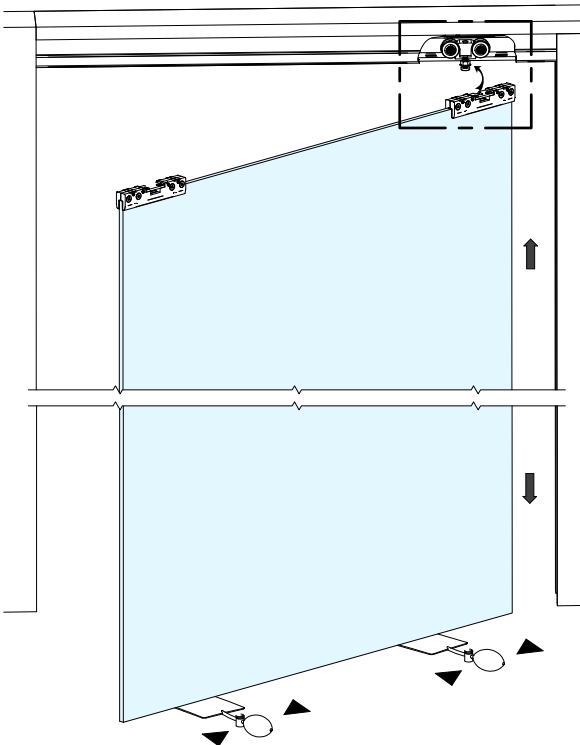

HEIGHT ADJUSTMENT

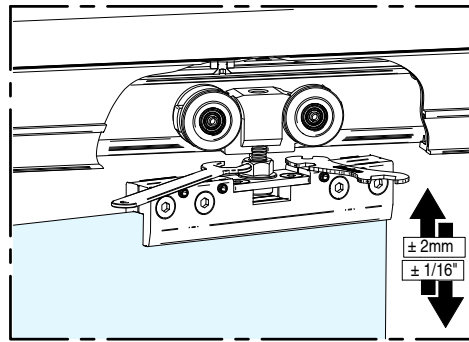

14 CLOSING SIDE ASSEMBLY

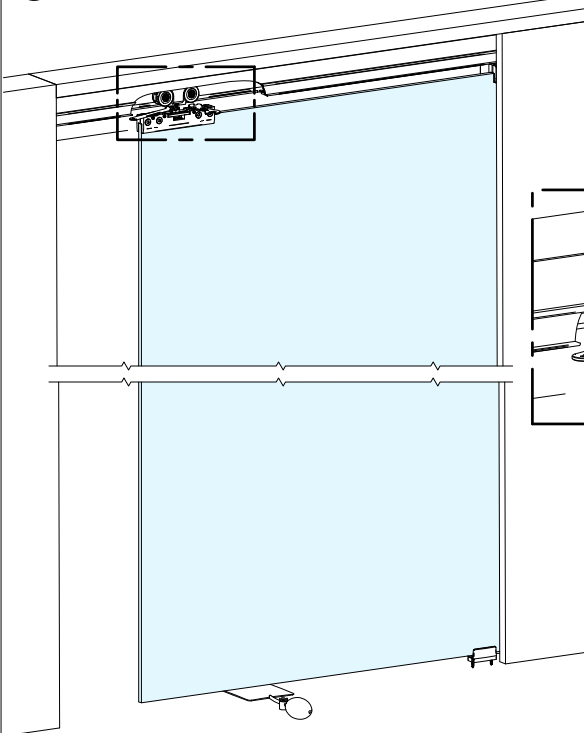

HEIGHT ADJUSTMENT

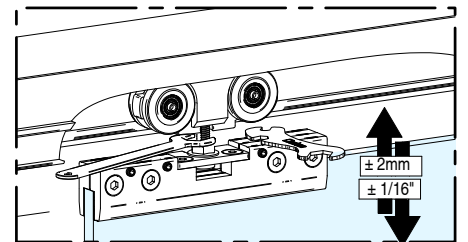

15 FIX PLASTIC CLIPS TO WOODEN PELMET

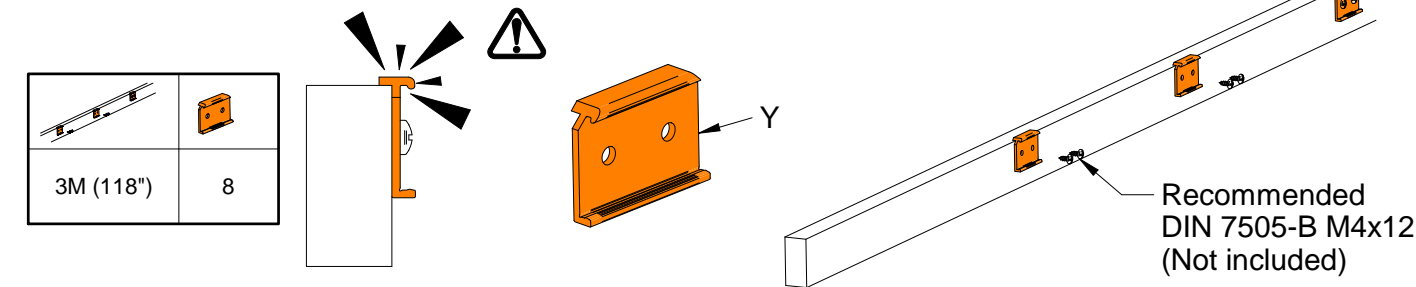

16 CEILING MOUNT: COVER CLIPPING

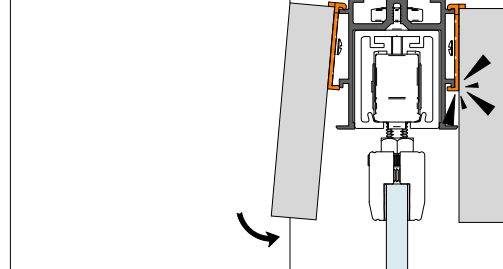

Link Hardware | 8131 Keele St unit #4, Vaughan, ON L4K 1Z2, Canada
 Phone: +1 905-761-5656
 Email: info@linkhardware.ca



SERIES POCKET MIDLAND SLIDER

JUN 2025

039008050

	00993110 (PKT1A)	S
	00993111 (PKT1MBL)	BL
X		1
Y		8

G		DIN 7505-B 5X25mm	8
H		DIN 7505-A 4X20mm	4
I		DIN 7982 4,2x16mm	1
J			1

K			1
R			1
S			1
T			2

U			2
V			2
W			2

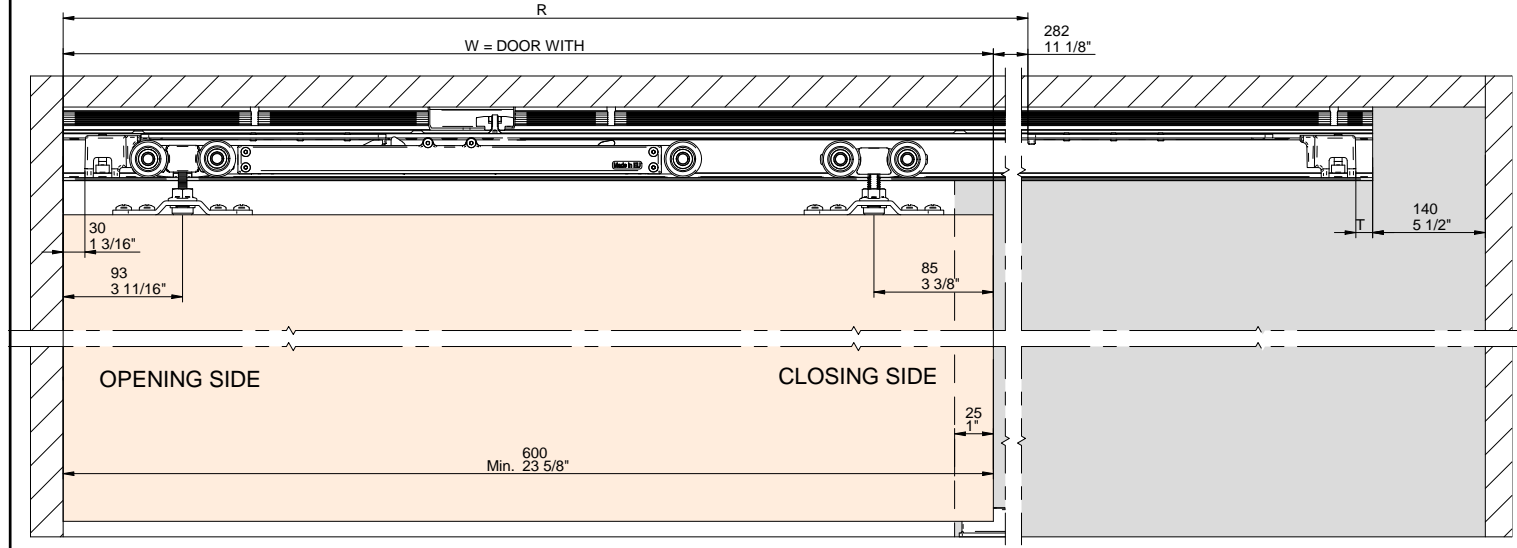
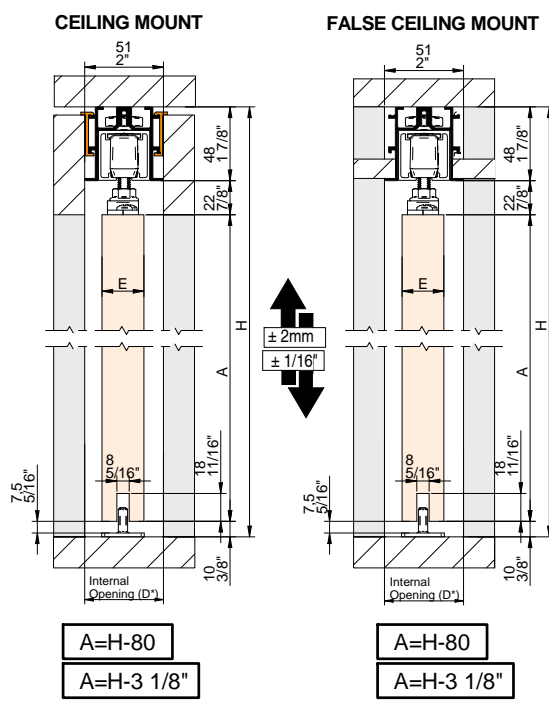

$D^* = E + 11\text{mm}$
*Min 51mm

$D^* = E + 7/16"$
*Min 2"

LEVELED ASSEMBLY

$T = 20$ $R = W + 282$

$T = 13/16"$ $R = W + 11 1/8"$

OVERLAP ASSEMBLY

$T = 20 + S$ $R = W + 282 + S$

$T = 13/16" + S$ $R = W + 11 1/8" + S$

ASSEMBLY PROFILES

$X = Y + 165$ $X = Y + 6 1/2"$
 $W = Y + 25$ $W = Y + 1"$
 $K = (Y \times 2) + 25$ $K = (Y \times 1/16") + 1"$

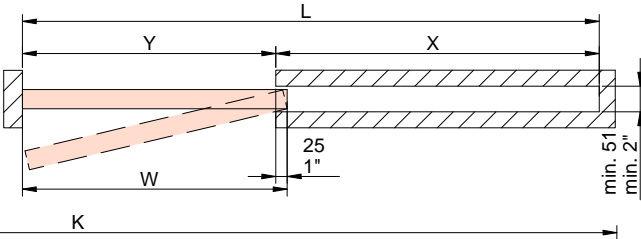

Y = Clear opening
W = Door

(Ymm)	(Y")	(Zmm)	(Z") MIN.
1100	43 5/16"	2100	82 11/16"
1200	47 1/4"	2100	82 11/16"
1300	51 3/16"	2300	90 9/16"
1400	55 1/8"	2500	98 7/16"
1500	59 1/16"	2700	106 5/16"
1600	63"	2800	110 1/4"
1700	66 15/16"	3000	118 1/8"
1800	70 7/8"	3400	133 7/8"

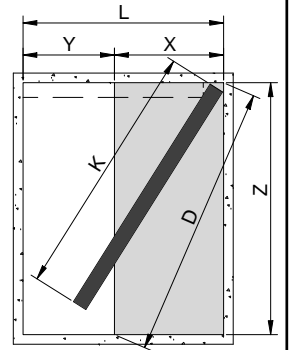

CUT PROFILE ALWAYS ON THIS SIDE



$K \leq D - 110$
 $K \leq D - 4 5/16"$

3 ASSEMBLY COMPONENTS

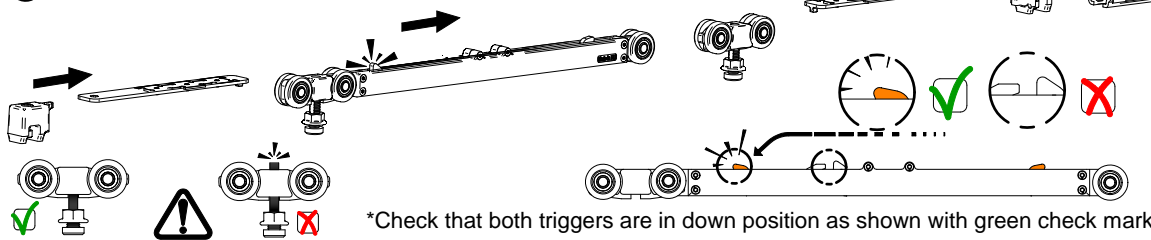

4 STOPPER

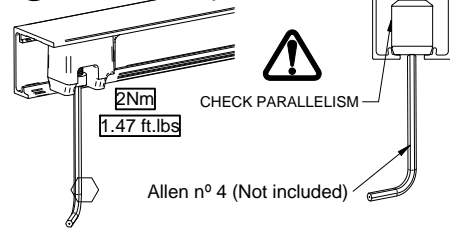

5 ASSEMBLY ACTIVATORS

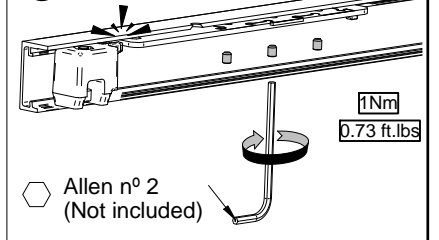

6 FIX SUPPORT TOP TRACK TO CEILING

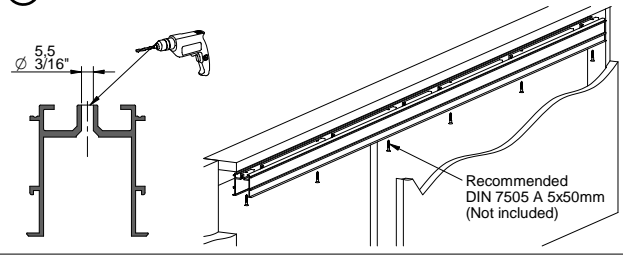

7 ACCOMODATE THE MAIN TOP TRACK TO SUPPORT TOP TRACK ALREADY FIXED

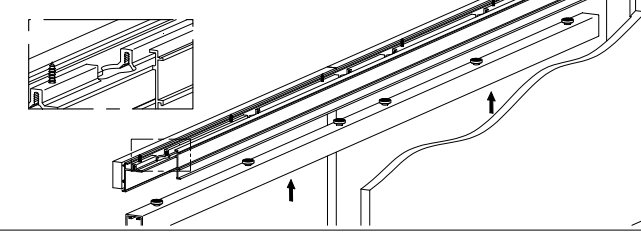

8 INSERT INTO SLOTS

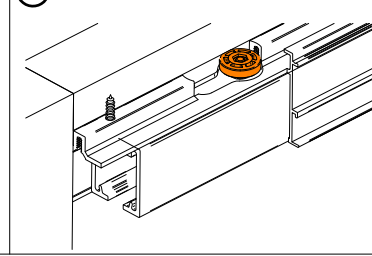

9 SLIDE UNTIL LIMIT

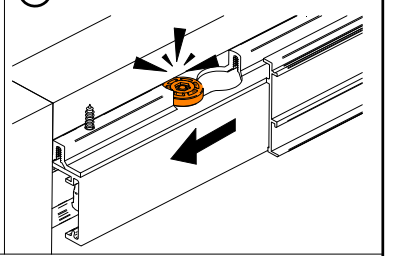

10 FIX THE TWO SCREWS (Z) IN THE CLEAR OPENING TO JOIN TRACKS

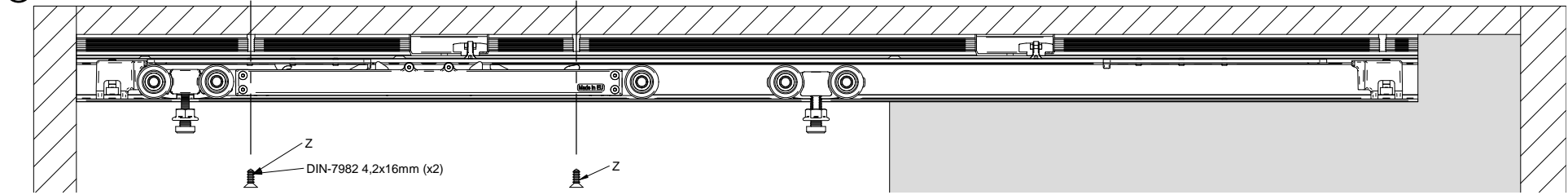

11 SURFACE FIX PLATES TO

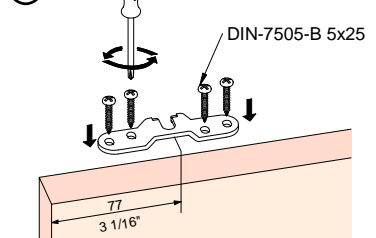

12 HANG DOOR AND ADJUST HEIGHT

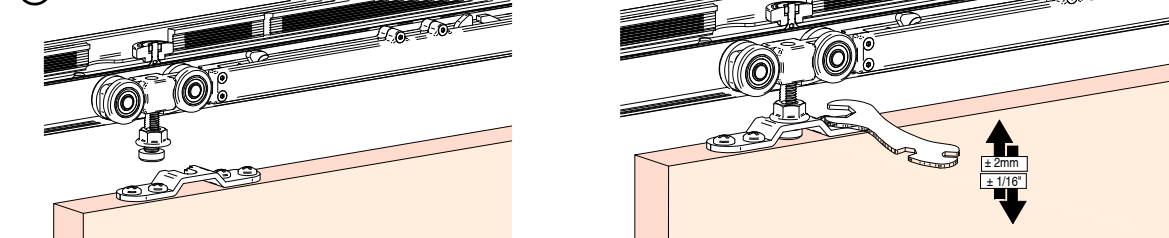

13 INSTALL BOTTOM GUIDE

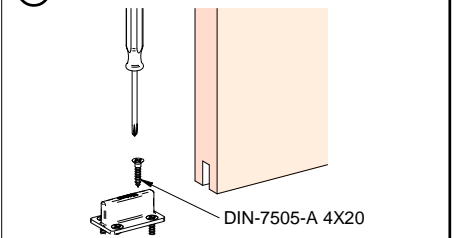

14 CLIP ON BRACKET FOR TIMBER PELMET

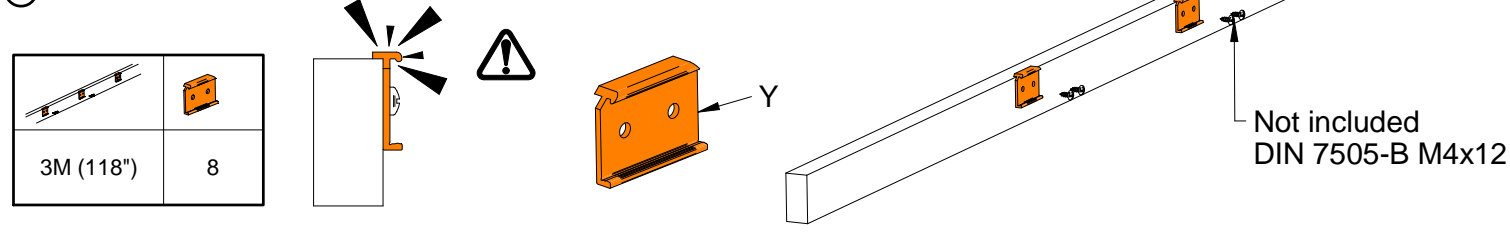

15 CEILING MONUT: COVER CLIPPING

